

## Instruction/InstallationSheet hideaway Recessed AV Media Plate p/n WPRP

### Parts Included:

1. WPRP Recessed AV Media Plate
2. Electrical Box optional use for electricians
3. Four (4) Screws

### Tools Needed:

1. Drywall Saw
2. 6 Ft. Tape Measure
3. Pencil
4. Screwdriver

Use hideaway Recessed AV Media Plate to install low voltage cables behind your flat panel TV, your amplifier or other audio and video devices. This media plate can be installed upright OR sideways.

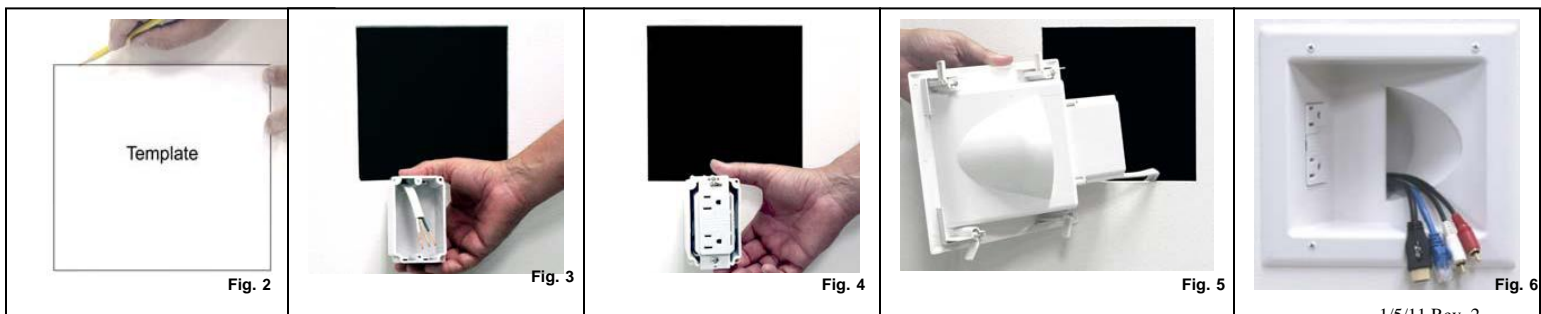

### InstallationInstructions:

- Fig. 1** Top view - shows needed space between the drywall and the studs. Receptacle side of the media plate must be 3" from the stud but no more than 5" (review picture carefully).
- Fig. 2** Using the template supplied (see page 2 of instruction sheet), trace the opening needed. Using a drywall knife, cut a hole in the drywall the size of the template. See Figure 1 before tracing your opening.
- Fig. 3&4** If installed by a qualified electrician use the Electrical box to run power cables.
- Fig. 5** Now use the four screws provided to secure the work box to the mounting studs on the backside of the of the media plate.
- Fig. 6** Pull all video and audio cords through the recessed opening. Starting with the receptacle side of the media plate, slowly slide the plate into the opening. Swing the opposite side of the plate into position until the entire media box is flush with the wall. Now screw down the screws with wings; these wings fasten tightly against the back of the drywall. Plug all necessary video and audio cables. Install your flat panel TV mounting bracket per the flat panel TV bracket manufacturer's instructions.

The **hideaway** Recessed AV Media Plate is the thinnest recessed wall plate available. Distributed in Australia by CABLEMASTER 1300 788 466. The Low profile design means the thinnest TVs and brackets can be installed as close as possible to the wall with enough room to store multiple AV and RF cables neatly behind your flat panel TV.